

TRI-COUNTY PROMENADE

11320 Princeton Pike
Cincinnati, OH 45246

FOR LEASE
2,964 SF

HIGHLIGHTS

- 2,964 SF available for lease
- One-half mile south of I-275
- Near City Center Springdale, the redevelopment of Tri-County Mall, as a \$1.2 billion mixed-use project
- Major retailers in the market include Burlington, Hobby Lobby, Lowe's, Sam's Club, TJ Maxx, Target, Ross and Value City Furniture
- Join Mitchell's Salon and Day Spa, FedEx, Crown Staffing and One Main Financial
- Terrific visibility, signalized intersection
- Close to 150,000 people in a 5-mile radius earning \$115,000 AHI

TRAFFIC COUNTS

- 134,917 VPD on I-275 E of Princeton Pike
- 29,352 VPD on SR 747 (Princeton Pike)

DEMOGRAPHICS

2024 Estimates	1 mile	3 miles	5 miles
Population	4,980	46,834	145,846
Households	2,279	19,106	59,990
Average HH Income	\$96,378	\$87,081	\$114,648
Daytime Employees	11,306	61,569	133,394

CONTACT

Marianne Holewski 513-784-1106
mholewski@anchor-associates.com

Anchor
ASSOCIATES



ANCHOR
ASSOCIATES

4901 Hunt Road
Suite 102
Blue Ash, OH 45242

513-784-1106

www.anchor-associates.com

A MEMBER OF
CHAINLINKS
RETAIL ADVISORS

TRI-COUNTY PROMENADE

11320 Princeton Pike
Cincinnati, OH 45246

Anchor
ASSOCIATES



TRI-COUNTY PROMENADE

11320 Princeton Pike
Cincinnati, OH 45246



The information herein is not guaranteed. Although obtained from reliable sources, it is subject to errors, omissions and withdrawal from the market without notice.

TRI-COUNTY PROMENADE

11320 Princeton Pike
Cincinnati, OH 45246

City Center Springdale

Anchor
ASSOCIATES

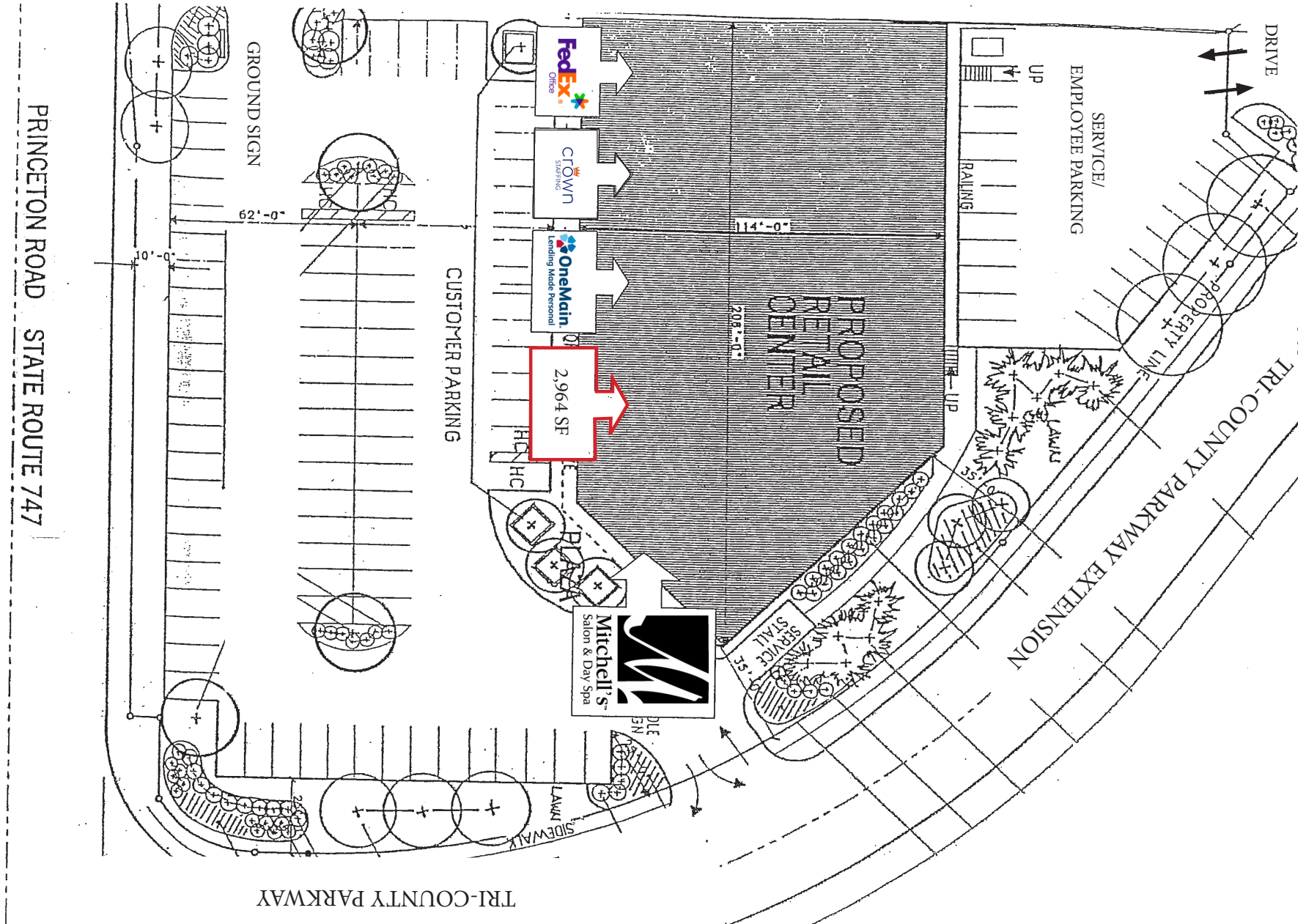

TRI-COUNTY PROMENADE

11320 Princeton Pike
Cincinnati, OH 45246

